

USER MANUAL

LINE G3030C(B)

LINE G3030K(B)

LINE G1616C

LINE G1616K

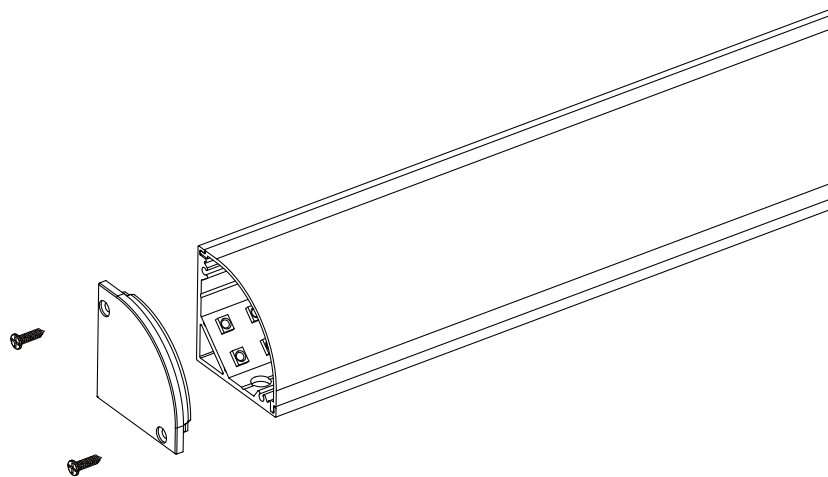

Please read the manual carefully before installation and application, and use the product in the correct way.

Instructions on accessories are included in the manual.

Please properly maintain the manual after reading and understanding it for convenient reference by all users of the product in the future.

CONTENTS

01 Components

02 Installation

Surface mounted

03 Cutting

04 Applications

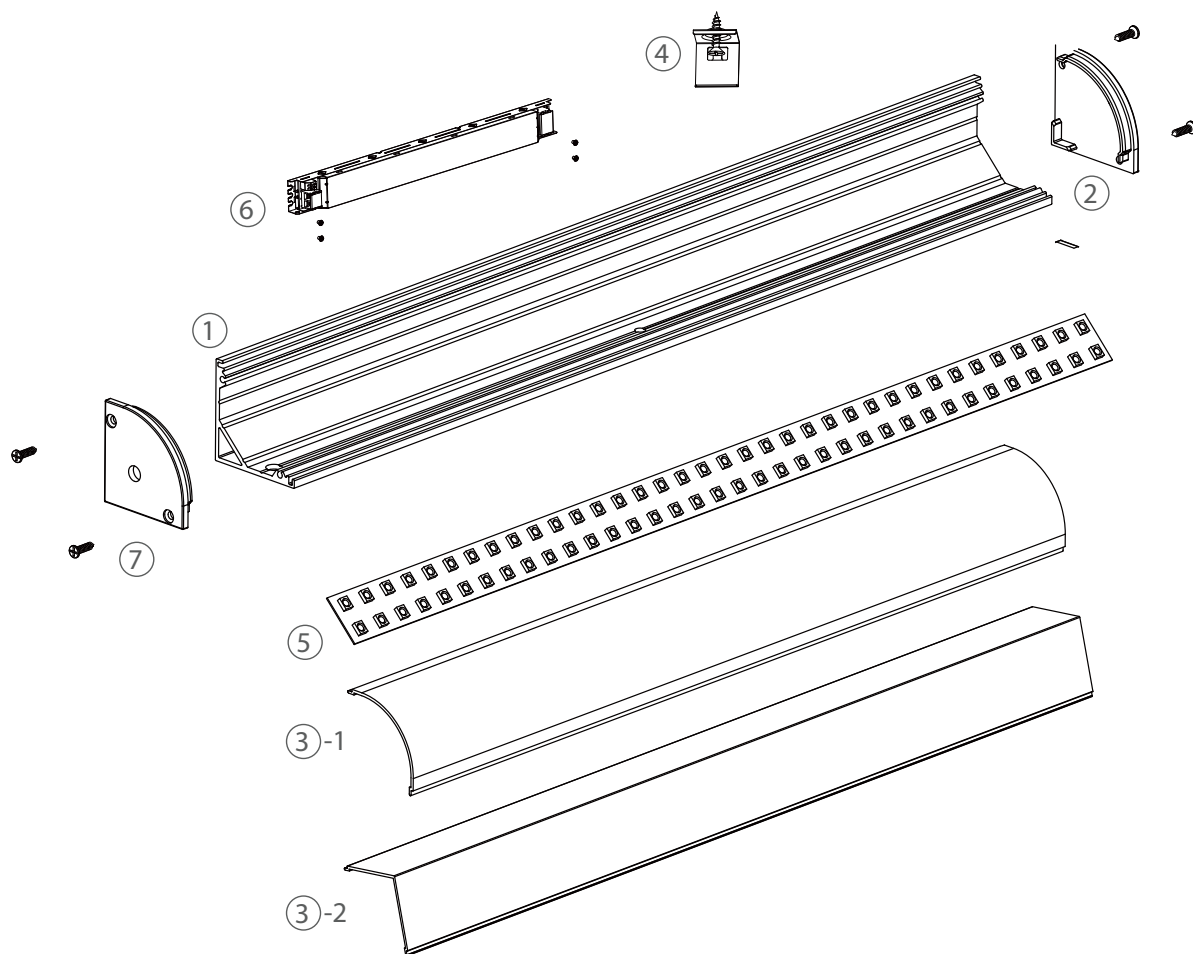

Essential

- ① Profile x1
- ② End cap x4
- ③-1 "C" Diffuser x1
- ③-1 "K" Diffuser x1
- ④ Clip x8

Others*

- ⑦ End cap with hole

Lighting Source and Power Supply*

- ⑤ Flexible strip
- ⑥ Power supply

* Optional parts

Installation

Surface mounted

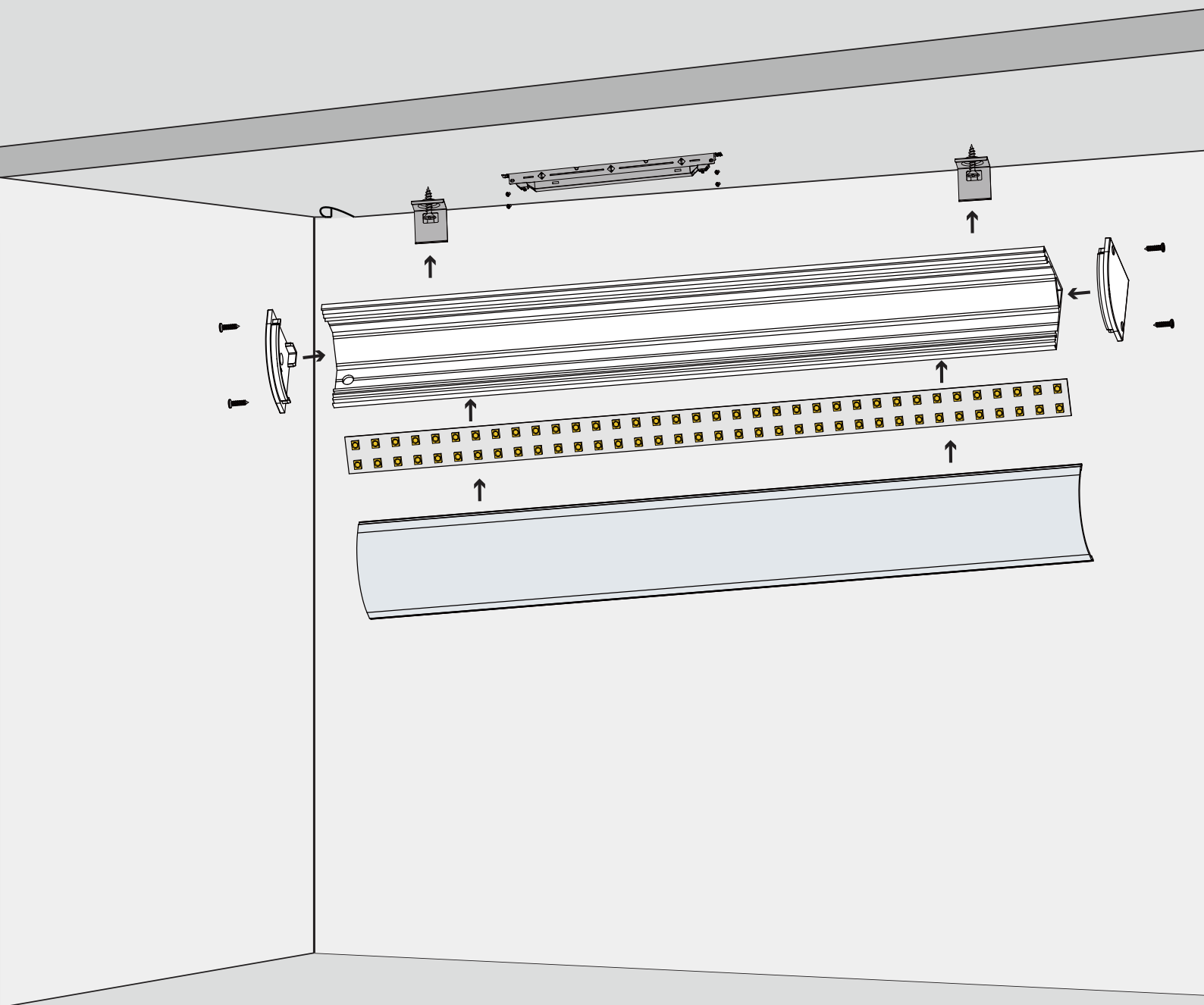

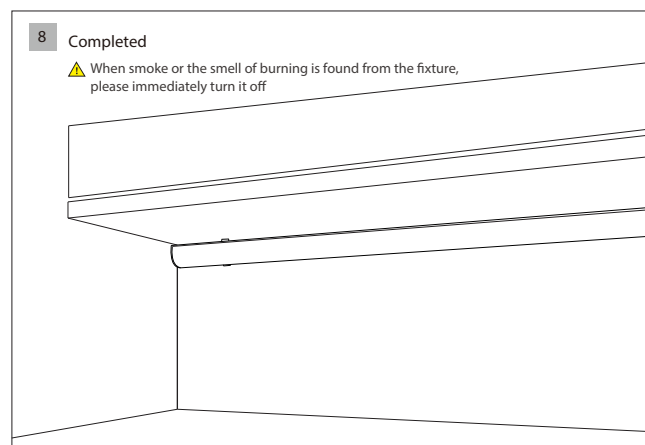
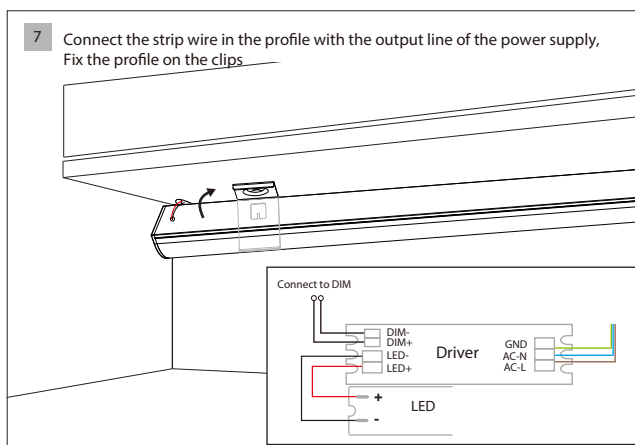
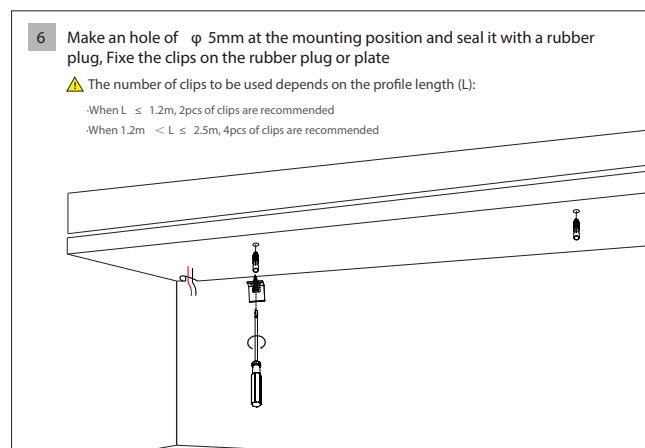
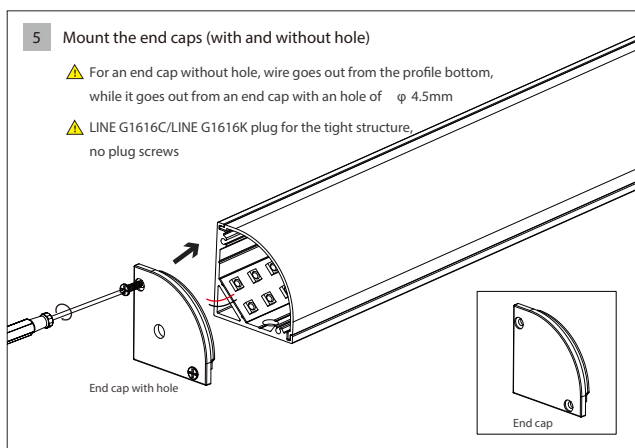
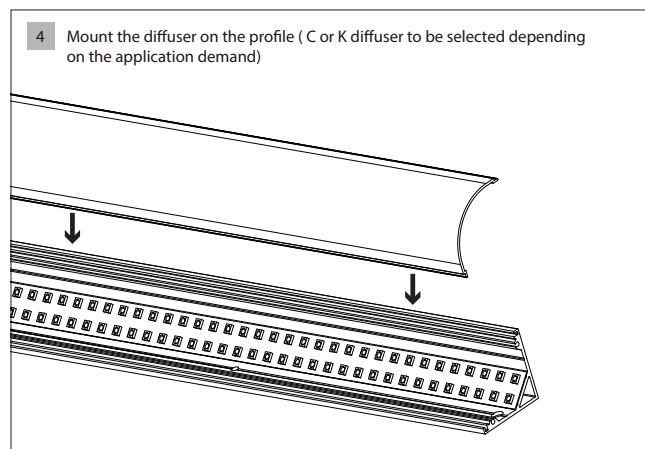
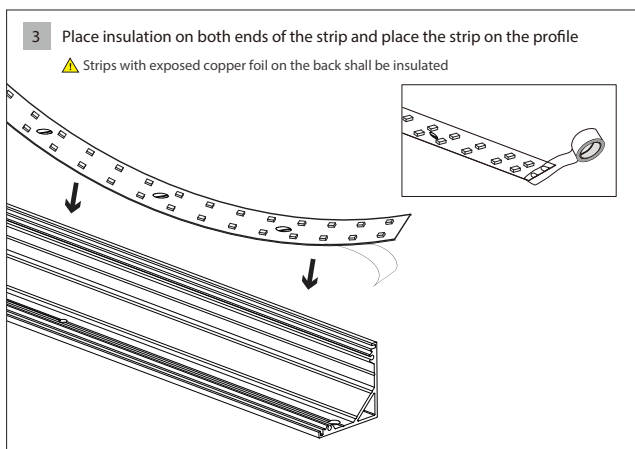
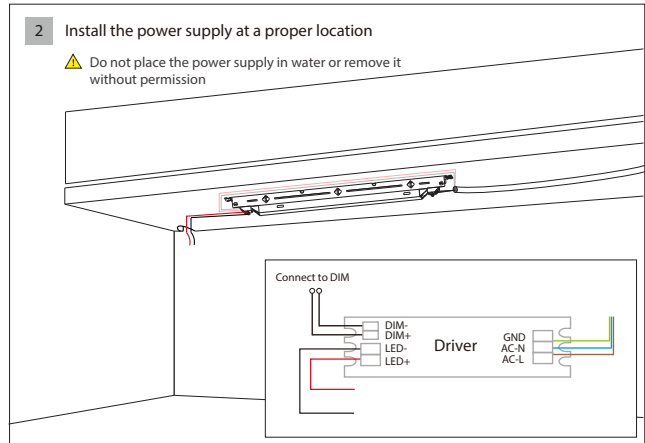
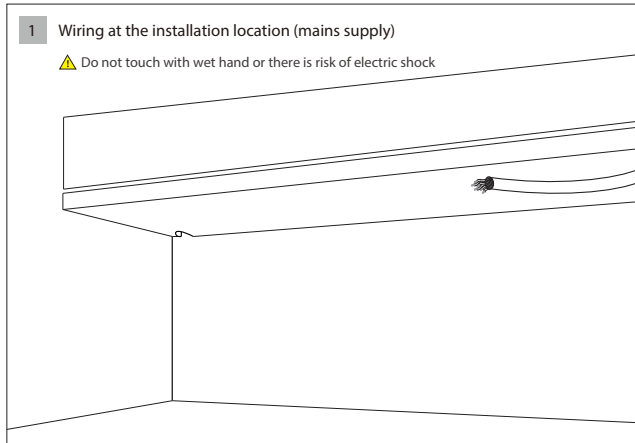

Cutting

1 Mount the diffuser on the profile

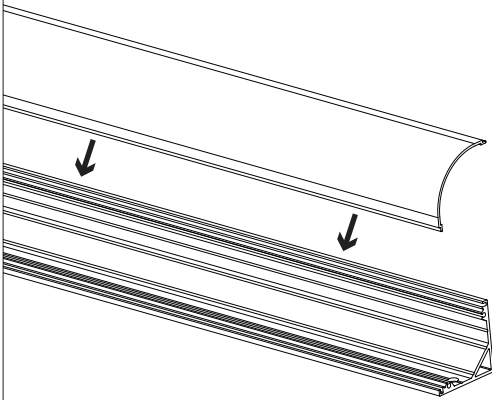

2 Mark the length to the cut off (profile loss will occur during cutting by about the thickness of the blade), and please make reservations of profile length

⚠ When the wire goes out from the profile bottom and end cap, the length to be cut off is a multiple of the minimum cutting unit of the strip + wire length going out (For LINE G3030C(B)/LINE G3030K(B) 8mm wire will be led out, and 10mm for LINE G1616C/LINE G1616K).

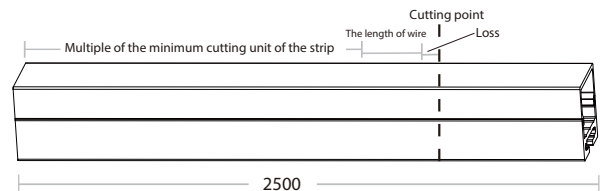

3 Profile cutting by a cutting machine

- ⚠ It is recommended to set the speed at 1,000 – 1,200rpm. Too high a speed may cause damage to the diffuser
- ⚠ A light source is not slowed to be placed on the profile during cutting
- ⚠ Please make sure the product is firmly fixed during cutting. The break shall be ground smooth to remove burr after cutting, and metal chips shall be completely removed from inside the track

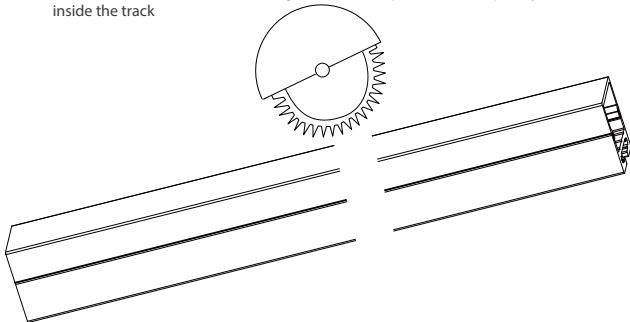

4 Cut the strip to match the profile and weld the red and black wire on one end of the strip

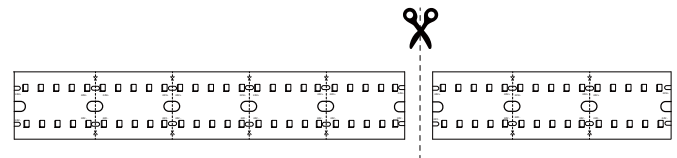

5 When the wire goes out from the end cap, it is unnecessary to make an hole in the profile. When it goes out from the profile bottom, an hole is to be made, as shown in the figure below

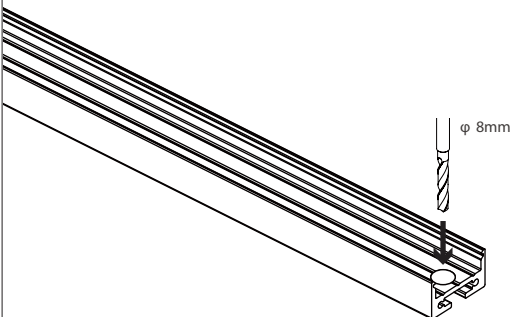

Applications





www.switch-made.com