

NOT » LINE MAX USER MANUAL

NOTES AND SAFETY INSTRUCTIONS



CAUTION :

Installation should be performed only by qualified electrician .

- Make sure no voltage while installation .
- Connect cable wires according to wire labeling.
- Max current should not exceed 16A in one power feed in circuit.

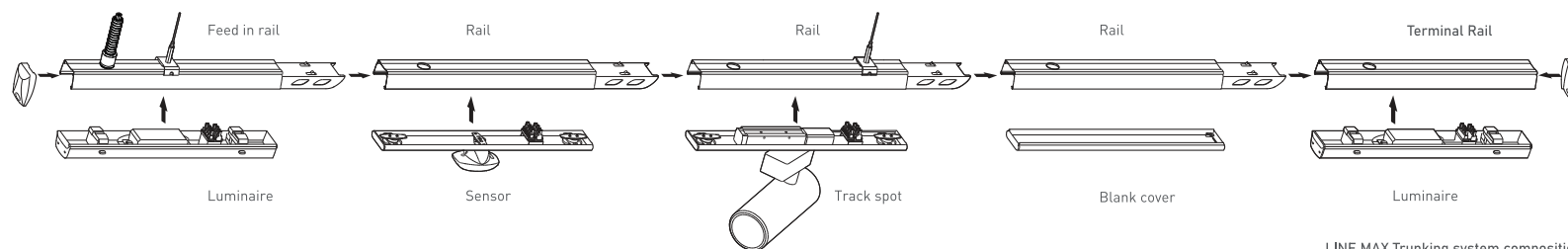

LINE MAX Trunking system composition

Terminal module:

Terminal module can be independently installed as a single unit, it also can be connected at end of one linear light row.

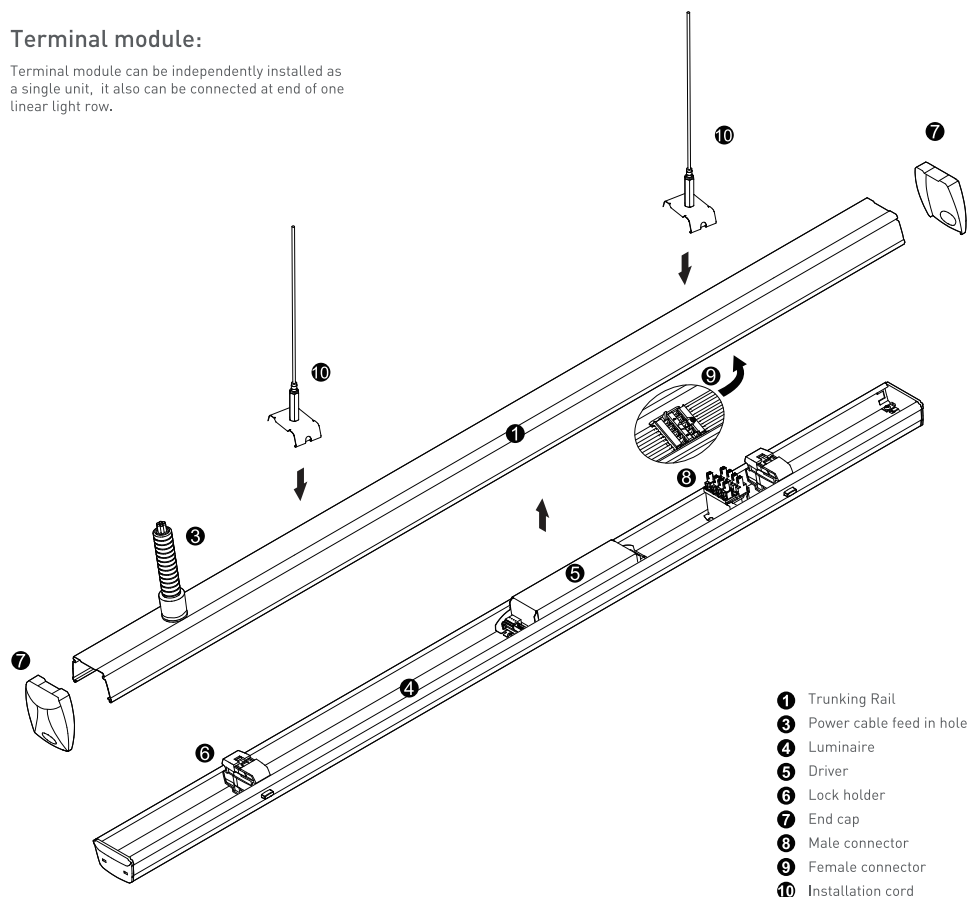

- 1 Trunking Rail
- 2 Power cable feed in hole
- 3 Luminaire
- 4 Driver
- 5 Lock holder
- 6 End cap
- 7 Male connector
- 8 Female connector
- 9 Installation cord
- 10 Installation cord

1. Mounting Suspension

Drill a hole on ceiling

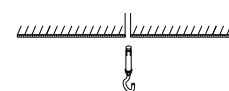

Fix mounting hook into ceiling

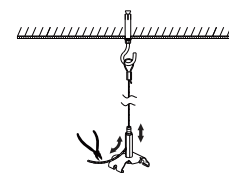
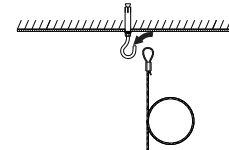

Adjust length of suspension cord:
a. press down Hexagon bolt;
b. Pull in/out cord to adjust length

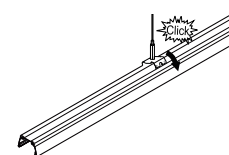

Click in mounting clip into trunking rail

2. Connecting Power Supply



Cut the Rubber cap to pass the power cable



Screw in the conduit gland

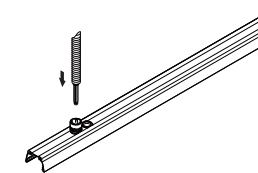

Put in conduit with cable inside and pull up conduit gland to lock



Connect wires according labeling on wires to feed in connector then connect to connector in trunking rail

3. Mounting Luminaire

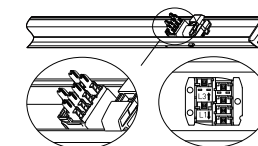

Slide knob to select phase L1/L2/L3

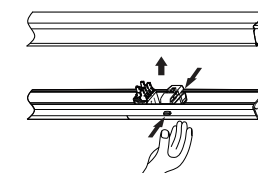

Make sure male & female connectors in right position then fix the luminaire to trunking rail

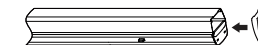

Push the sliding lock to lock the luminaire to trunking rail

NOT » LINE MAX USER MANUAL

Trunking Rail and Luminaire

First trunking rail should have one side connecting plate&last trunking rail with no connecting plate on both sides , then fix the Luminaire to trunking rail then lock holder, then keep end caps at both sides.

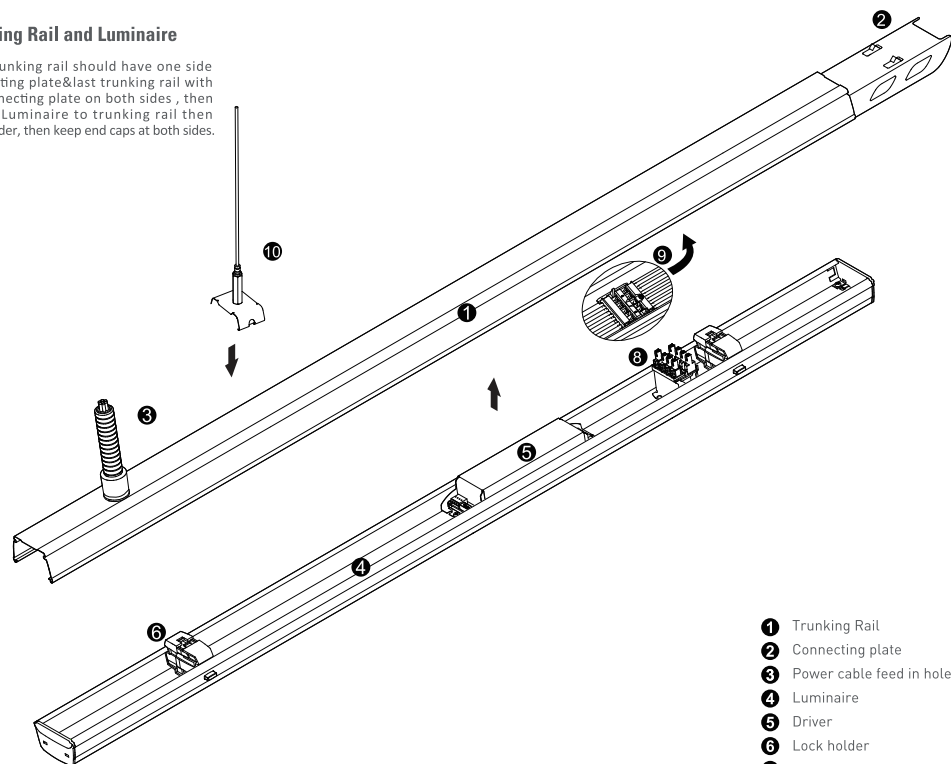

Wire diagram of triple circuits function

- 1 Trunking Rail
- 2 Connecting plate
- 3 Power cable feed in hole
- 4 Luminaire
- 5 Driver
- 6 Lock holder
- 8 Male connector
- 9 Female connector
- 10 Installation cord

1. Mounting Suspension

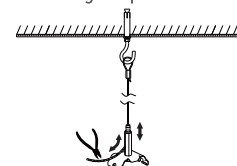

Adjust length of suspension cord:
a. press down Hexagon bolt;
b. Pull in/out cord to adjust length

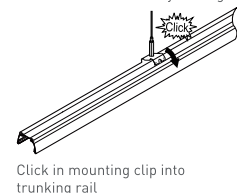

Click in mounting clip into trunking rail

2. Connecting Power Supply

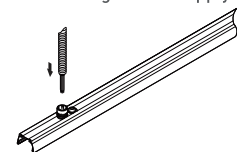

Put in conduit with cable inside and pull up conduit gland to lock



Connect wires according labeling on wires to feed in connector then connect to connector in trunking rail

3. Connecting Trunking Rail

Both trunking rails should keep in perfect position then push to click

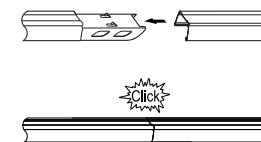

4. Mounting Luminaire

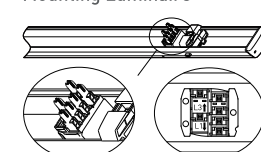

Slide knob to select phase L1/L2/L3

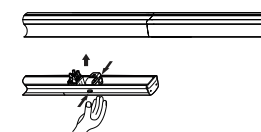

Make sure male & female connectors in right position then fix the luminaire to trunking rail



5. LED linear lighting system



Including luminaires

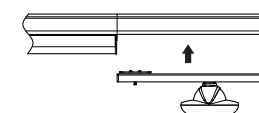

Including luminaires and sensor

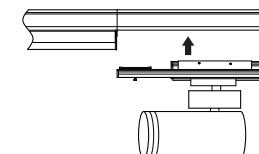

Including luminaires and spotlight



Including luminaires and black cover

3 Circuit Wiring Diagram

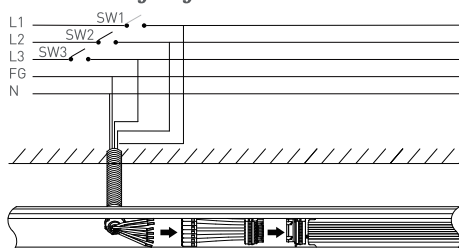

This 3 Circuits function offers to control lighting ON/OFF by three switches SW1,SW2,SW3 which are connected by live lines L1,L2,L3

Pendant mounting instruction

Starting Installation distances point should be 800 mm to 1000 mm, then in between 1st & 2nd point should be 3000 mm max

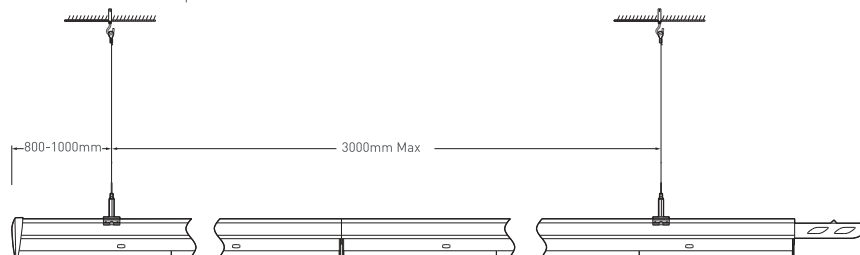

Four options for installation (to be ordered separately)

