

FT »

KAIDO P2-35

TECHNICAL DATA

	100-277 Vac	IP66	IK08	CRI >70/>80	130 lm/W	CREE LED	DIMMABLE 1-10V / DALI Optional
---	-------------	------	------	-------------	----------	----------	---

New innovative KAIDO family with modularity in choice of design and application, high-quality outdoor post-top lighting fixture, high efficiency and comfort uniform lighting distribution, <3 SDCM, precise and elegant illumination, high visual comfort, elegant form factor, self-cleaning, smooth surface, compact and ultra-thin die-cast aluminium body, clips design tool-free to open the housings, different types of mounting options, optional control modes, integrated driver, power-off protector, safe for maintenance, optional power model of 24W and 78W, designed for installation heights of 2.5m to 6.0m, delivered with 0.5m cable, mounting pole not included.

DRIVER CC, 0.86A, 20-41Vdc	Lighting Control Standard <input type="checkbox"/> 1-10V <input type="checkbox"/> DALI
CRI	Standard <input type="checkbox"/> CRI >70 <input type="checkbox"/> CRI >80
BEAM OPTIONS	
FINISH	<div> <i>Grey</i> RAL9007 (GY) </div> <div> <i>Dark Bronze</i> RAL8019 (DB) </div> <div> <i>Black</i> RAL9005 (BK) </div>

TECHNICAL DATA

LED	: CREE SMD3030
System Power	: 35 W
MacAdam Step	: SDCM <3
Luminaire Efficacy	: 133 lm/W (@5000K)
Lifetime	: L ₇₀ B ₅₀ 50,000Hrs, Ta@35°C
BUG Rating	: B1 U1 G1

GENERAL

Mounting	: Pole mounted, Outdoor
Housing	: Die-cast aluminium (AKZO polyester powder coating)
Lens	: PC
Diffuser	: Tempered glass (4mm thick)
Adjustability	: No
Driver Mounting	: Integrated
Emergency kit	: Not available

IP Rating	: IP66
IK Rating	: IK08
Protection Class IEC	: I
Energy Class	: A++
Working Temp.	: -55° to 55°C
Glow-wire test	: 960°C
Weight	: 8.80 Kg
Warranty	: 3 yrs (extendable to 5 yrs)

2700K 3000K 4000K 5000K 5700K

FT



KAIDO P2-35

TECHNICAL DATA



KAIDO P2-35



COLOR TEMP.	POWER	LUMENS	CODE
3000K	35 W	4375 lm	EXT13125-30K
4000K		4550 lm	EXT13125-40K

2700K 3000K 4000K 5000K 5700K

DIMENSION

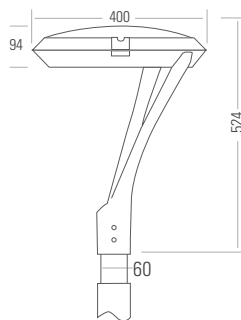

OPTIONAL



KAIDO POLE TOP 1



KAIDO POLE TOP 2



KAIDO POLE TOP 3



KAIDO LOW BAY



KAIDO CATENARY



KAIDO WALL MOUNTED

NOTES

ISO DOC. NO.: SM-OPN-QSF08

CE RoHS

PROJECT
LUMINAIRE REF.
QUANTITY
DATE

Contact Name
Mobile
Email

www.switch-made.com

Updated on April 15, 2022

All technical specifications and datas are subject to modification at any time and without notice.
The rated values (@ta25°C) of luminous flux and electrical load are subject to initial tolerance of +/- 10%. Tolerance of CCT are subject to +/- 150K.