



FT



## DECONUT PENDANT 2000

### TECHNICAL DATA



	22-240Vac 50/60Hz	IP20	CRI >80/>90	OSRAM LED	DIMMABLE 1-10V/DALI Optional
---	----------------------	------	----------------	-----------	------------------------------------

The whole series of decorative LED FRAME solution utilizes a uniform extruded aluminium housing with lesser trim size, sleek and seamless design, uniformly lighted through an PC diffuser, streamlined aesthetic, perfect solution for general illumination, high visual comfort, higher stability of color rendition, with surface mounting and suspended options, supplied with power supply.

DRIVER  
CC, 2x1500mA, 36VDC

Lighting Control

Standard Phase 1-10V DALI

CRI

Standard  
CRI >80 CRI >90

BEAM ANGLE



FINISH

White (WH)  
RAL9016 Black (BK)  
RAL9004

#### TECHNICAL DATA

LED	: OSRAM 2835 LED
System Power	: 126 W
MacAdam Step	: SDCM <3
Luminaire Efficacy	: 85lm/W @3000K
Lifetime	: L <sub>80</sub> B <sub>10</sub> 50,000Hrs, Ta@35°C
UGR	: <22

#### GENERAL

Mounting	: Suspended, Indoor
Housing	: Extruded Aluminium
Suspension	: Aircraft Stainless Rope, Metal Ceiling Canopy
Diffuser	: PC (85% Transmittance)
Adjustability	: No
Driver Mounting	: Integrated (Inside canopy for DALI)
Dimmable:	: Yes
Emergency Kit	: Optional Available

IP Rating	: IP20
IK Rating	: IK05
Protection Class IEC	: II
Energy Class	: A+
Working Temp.	: -35°C to 45°C
Glow-wire test	: 960°
Weight	: 13.00 Kg.
Warranty	: 3 yrs (extendable to 5 yrs)

3000K 4000K 6000K



[www.switch-made.com](http://www.switch-made.com)

All technical specifications and datas are subject to modification at any time and without notice.  
The rated values (@ta25°C) of luminous flux and electrical load are subject to initial tolerance of +/- 10%. Tolerance of CCT are subject to +/- 150K.

FT »

# DECONUT PENDANT 2000

## TECHNICAL DATA



### DECONUT PENDANT 2000



COLOR TEMP.	POWER	LUMENS	NO. OF PARTS	CODE
3000K	126 W	10710 lm	4	INT20044-30K-126W

3000K 4000K 6000K

#### DIMENSION

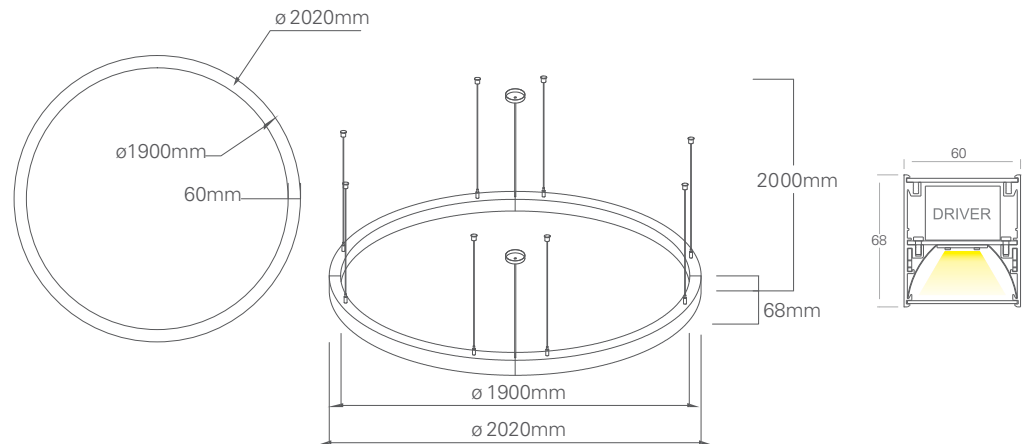

#### NO. OF PARTS

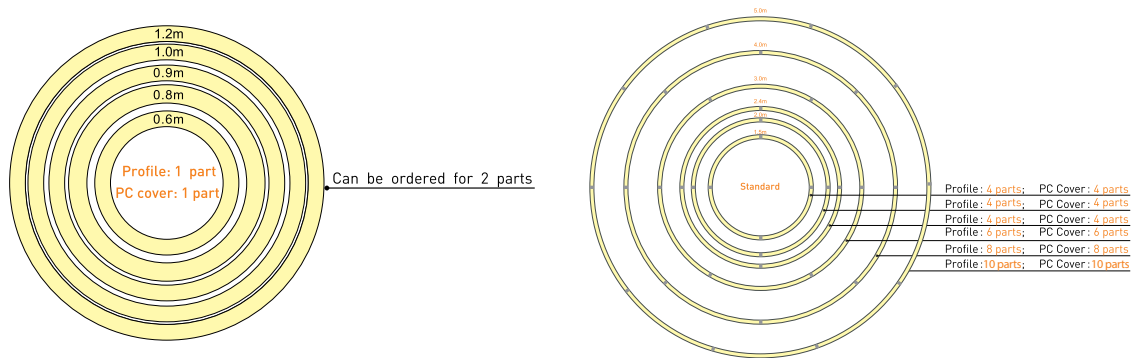

#### NOTES

PROJECT	
LUMINAIRE REF.	
QUANTITY	
DATE	
Contact Name	
Mobile	
Email	

ISO DOC. NO.: SM-OPN-QSF08

CE RoHS